

FK SERIES

ROTATING PULVERIZER WITH KIT FRANTUMATORE GIREVOLE CON KIT

HARDOX®
IN MY BODY

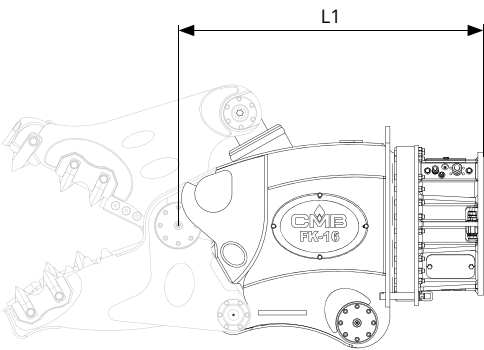

Drain line advised
Drenaggio consigliato

FK SERIES			FK 10	FK 16	FK 20	FK 30	FK 40
	EXCAVATOR WORKING PRESSURE	bar	300-350	350	350	350	350-400
	EXCAVATOR OIL FLOW	l/min	200-250	250	250	300	350-450
	L1	mm	1250	1380	1440	1500	1650
	ROTATION WORKING PRESSURE	bar	120	120	120	120	140
	ROTATION OIL FLOW	l/min	10	20	20	20	40
	SPEED VALVE		OPT	OPT	YES	YES	YES

FK SERIES + FH KIT



FK SERIES + CC KIT



FK SERIES + CR KIT



Attachment-excavator couplings data are for information only, always check load diagram of the machine.

I dati relativi agli accoppiamenti attrezzatura-escavatore sono da considerarsi puramente indicativi, controllare sempre i diagrammi di carico della macchina operatrice.

➤ ROBUST FRAME IN HARDOX 450
STRUTTURA ROBUSTA IN HARDOX 450

➤ QUICK KIT CHANGE
KIT CHELE IN AGGANCIO RAPIDO

➤ MULTI PURPOSE WITH INTERCHANGEABLE JAWS
VERSATILITÀ CON CHELE INTERCAMBIABILI

➤ INTERCHANGEABLE THEETH
DENTI INTERCAMBIABILI

Innovative, versatile, robust and fast, we simply put our new product composed of a main body which can change quickly the kits can deal with the different situations of the building site.

- > 4 times reversible blades
- > 360° continuous hydraulic rotation
- > Inverted mounted cylinder
- > Speed Valve

Innovativo, versatile, robusto e veloce, in poche parole il nostro nuovo prodotto composto da un corpo attrezzatura al quale poter cambiare in modo rapido i kit può affrontare le diverse situazioni del cantiere.

- > Lama 4 profili
- > Rotazione idraulica a 360°
- > Cilindro completamente protetto e rovesciato
- > Valvola di velocità

FH KIT

DEMOLITION KIT
KIT DEMOLIZIONE

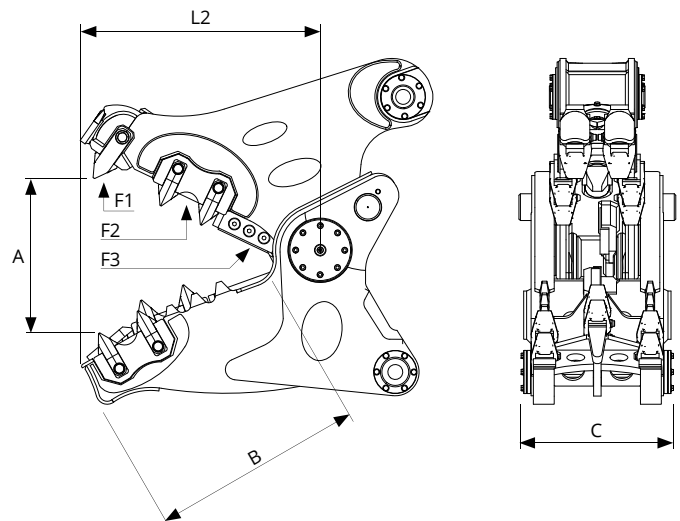

FH KIT	FK 10	FK 16	FK 20	FK 30	FK 40	
BODY WEIGHT	kg	875	1100	1285	1875	2250
KIT WEIGHT	kg	615	800	865	1325	1720
TOTAL WEIGHT	kg	1490	1900	2150	3200	3970
EXCAVATOR WEIGHT	ton	10 - 17	17 - 24	21 - 35	33 - 48	45 - 55
L2	mm	800	860	910	980	1070
L1+L2	mm	2050	2240	2350	2480	2720
A	mm	550	665	800	900	1020
B	mm	620	720	780	840	910
C	mm	415	450	480	520	550
BLADE	mm	120	195	195	300	300
F1	ton	60	80	85	110	135
F2	ton	100	135	140	180	200
F3	ton	150	200	245	330	380

Attachment-excavator couplings data are for information only, always check load diagram of the machine.

I dati relativi agli accoppiamenti attrezzatura-escavatore sono da considerarsi puramente indicativi, controllare sempre i diagrammi di carico della macchina operatrice.

FK SERIES



HARDOX®
IN MY BODY

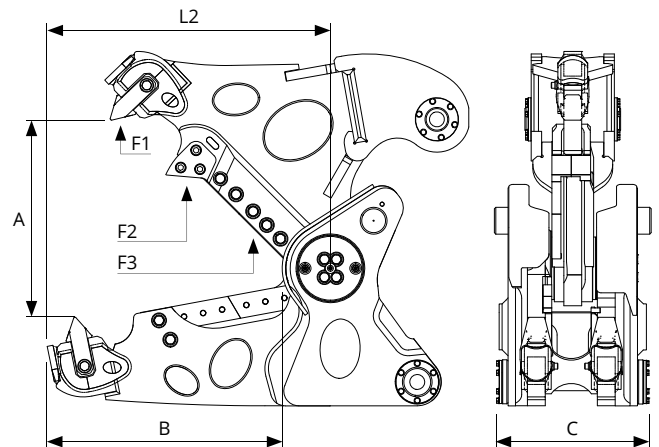

CC KIT

COMBI KIT
KIT COMBI



CC KIT		FK 10	FK 16	FK 20	FK 30	FK 40
BODY WEIGHT	kg	875	1100	1285	1875	2250
 KIT WEIGHT	kg	725	900	965	1425	2000
TOTAL WEIGHT	kg	1600	2000	2250	3300	4250
 EXCAVATOR WEIGHT	ton	10 - 17	17 - 24	21 - 35	33 - 48	45 - 55
L2	mm	870	995	1130	1220	1330
L1+L2	mm	2120	2375	2570	2720	2980
A	mm	510	645	780	870	980
B	mm	790	830	890	950	1020
C	mm	315	350	380	410	450
 BLADE	mm	420	510	605	675	750
F1	ton	55	75	85	120	150
F2	ton	85	110	140	180	210
F3	ton	160	200	245	660	800



Attachment-excavator couplings data are for information only, always check load diagram of the machine.

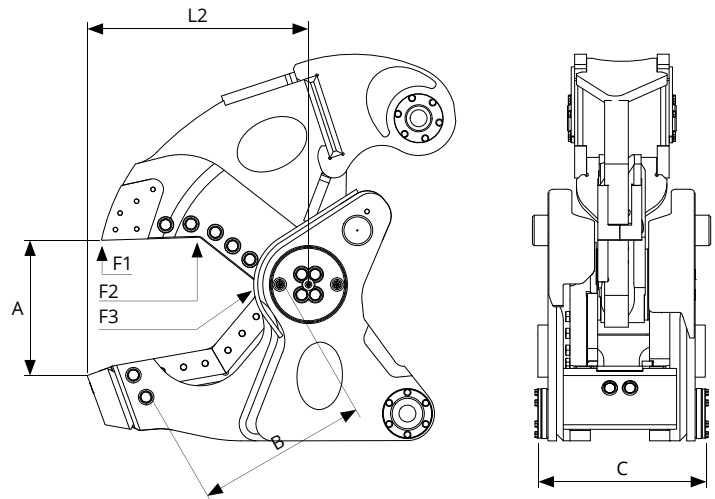

CR KIT

**SHEAR KIT
KIT CESOIA**



CR KIT		FK 10	FK 16	FK 20	FK 30	FK 40
BODY WEIGHT	kg	875	1100	1285	1875	2250
 KIT WEIGHT	kg	665	850	915	1375	1850
TOTAL WEIGHT	kg	1540	1950	2200	3250	4100
 EXCAVATOR WEIGHT	ton	10 - 17	17 - 24	21 - 35	33 - 48	45 - 55
L2	mm	650	700	760	840	940
L1+L2	mm	1900	2080	2200	2340	2590
A	mm	320	380	460	520	575
B	mm	420	500	600	640	700
C	mm	320	355	390	440	500
 BLADE	mm	400	480	580	650	725
F1	ton	70	100	130	175	210
F2	ton	110	160	240	325	400
F3	ton	185	300	520	700	715

Attachment-excavator couplings data are for information only, always check load diagram of the machine.

I dati relativi agli accoppiamenti attrezzatura-escavatore sono da considerarsi puramente indicativi, controllare sempre i diagrammi di carico della macchina operatrice.